



Design made easy for OEMs.

**ASCO™ Series 252 Modular Dental Manifolds**  
Providing modular fluidic control options for virtually any dental delivery system.



# The ASCO™ Series 252 manifold defines new standards for the use of miniature solenoid valves in dental applications.

The choice of superior materials and the total electrical containment of these modular dental manifolds are just some characteristics that make them the superior technical solution.

## Versatility

Several configurations of the ASCO Series 252 dental manifolds have been developed to provide the most versatility to the OEM. One such variation includes a gas proportional valve that is used to precisely control the turbine motor that regulates the speed of the hand-piece by the operator, typically via foot-pedal control.



## Efficient reliability

The fluidic connection ports are constructed of brass to provide worry-free connections and corrosion-resistant reliability. Depending on the configuration of the manifold, the barbed ports vary in size to provide the most efficient media flow through the assembly.

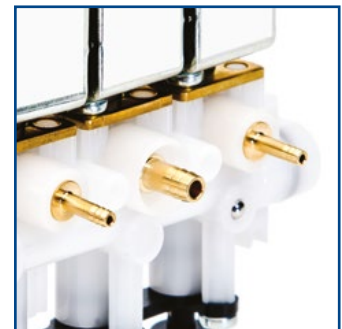

## Isolation of fluids

Another benefit of the ASCO Series 252 dental manifolds is the use of isolation valves for water irrigation and flushing procedures. Isolation valves offer the required containment of liquids flowing through the dental delivery system, which results in exceptional service lifetime and minimal maintenance.

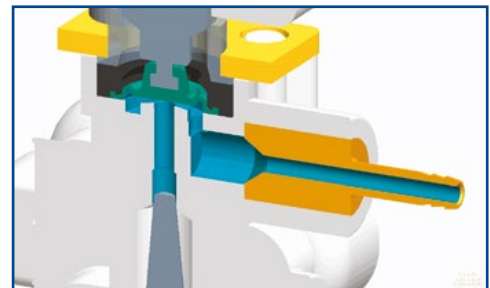

## Modular Design

Each manifold assembly is designed with modularity in mind; assemblies can be daisy-chained together to create larger assembly banks based on the unique requirements of differing delivery systems.

A particular manifold assembly is equipped with a single isolation valve. The two open ports allow for syringe and/or scaler instruments to be connected that do not require valving.



# Superior modular fluidic control



## Manual flow controller

Each of the three fluidic channels is equipped with a manual flow controller to provide the most versatility and functionality to the end user.



## Designed-in flexibility

For maximum flexibility, inlet port kits (provided separately) have been designed that provide all the necessary connection elements that are required during installation. A stainless steel positioning pin is included to provide quick, safe, and accurate alignment.



Versions	Manifold with 3 Microactuators Series 252-01	Manifold with 3 Microactuators Series 252-02	Manifold with 1 Microactuator Series 252-03
Valve type	<ul style="list-style-type: none"> <li>• 2x 2/2NC</li> <li>• 2/2NC – DRY</li> </ul>	<ul style="list-style-type: none"> <li>• 2/2NC</li> <li>• 2/2NC – Proportional</li> <li>• 2/2NC – DRY</li> </ul>	<ul style="list-style-type: none"> <li>• 2/2NC - DRY</li> </ul>
<b>Technical Features</b>			
Maximum allowable pressure (PS)	8 bar (116 psi)		
Opening time	~5ms to ~10ms		
Fluid temperature	-10°C to +90°C (+14 °F to +194 °F)		
Max. viscosity	3°E (22 cStokes or mm <sup>2</sup> /s)		
<b>Materials</b>			
Manifold body	POM		
Seals	EPDM (WRAS/KTW certified compound)		
Internal components	Stainless steel – PA66		
Guide assembly	Stainless steel		
Barbed ports	Brass		

# New standards for fluidic control design in dental delivery systems.



**ASCO**<sup>™</sup>

Where flow control meets pneumatics to create fluid automation solutions that maximize efficiencies, optimize applications, and enable customers to fulfill their true potential.

Our extensive product lines include a broad range of solenoid valves, angle body piston valves, valve manifolds, cylinders, filters, regulators, lubricators and accessories.

**Emerson Automation Solutions**  
ASCO Numatics GmbH  
Otto-Hahn-Str. 7-11  
75248 Ölbronn-Dürrn  
T. +49 7237 996 0  
E. [asconumatics-de@Emerson.com](mailto:asconumatics-de@Emerson.com)

**Emerson Automation Solutions**  
ASCO Valve Inc. – United States  
160 Park Avenue,  
Florham Park, NJ, 07932  
T. +1 (0)800-972-2726  
E. [info-valve@asco.com](mailto:info-valve@asco.com)

**Emerson Automation Solutions**  
ASCO ASIA – Singapore  
Blk 4008, Ang Mo Kio Avenue 10  
#04-17/22, TECHplace I  
Singapore 569625  
T. +65 6556 1100  
E. [valvesales@emerson.com](mailto:valvesales@emerson.com)



[asco.com](http://asco.com)



[Facebook.com/EmersonAutomationSolutions](https://www.facebook.com/EmersonAutomationSolutions)



[LinkedIn.com/company/Emerson-Automation-Solutions](https://www.linkedin.com/company/Emerson-Automation-Solutions)



[Twitter.com/ASCO\\_EU](https://twitter.com/ASCO_EU)

The Emerson logo is a trademark and service mark of Emerson Electric Co. Brand logotype are registered trademarks of one of the Emerson family of companies. All other marks are the property of their respective owners. © 2018 Emerson Electric Co. All rights reserved.



**CONSIDER IT SOLVED<sup>™</sup>**